

1. Clear a large work area for your tools and lay out the vinyl cover.

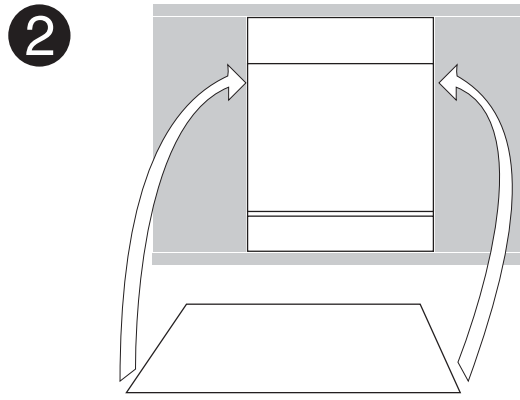

2. Make sure that your dishwasher has been cleaned with a mild cleaning solution and get your tape ready.

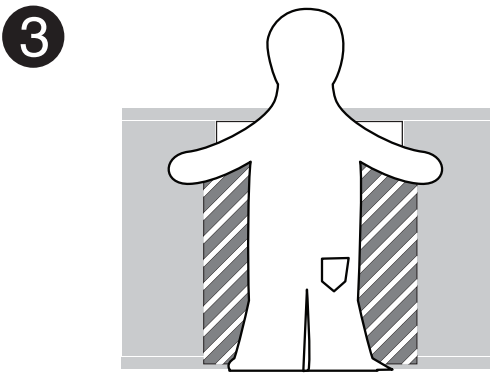

3. Using the top edge of the dishwasher as a guide, line up your vinyl cover parallel with the top edge of the machine, so there is excess material on every side.

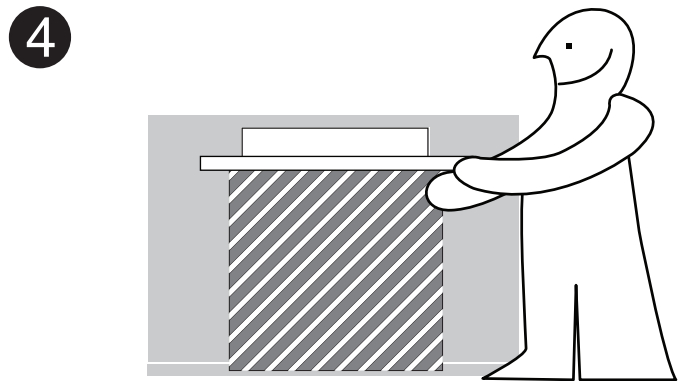

4. Tape in place along top edge.

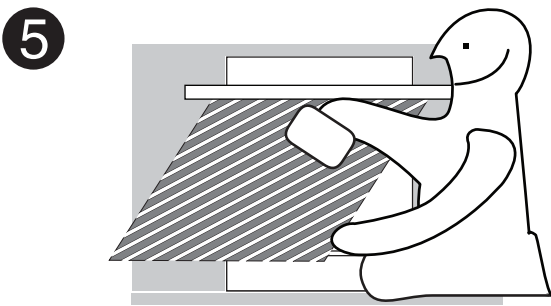

5. Lifting from the bottom, hold the material taut with one hand, and with the other peel back the backing in 2" - 5" sections, and squeegee into place.

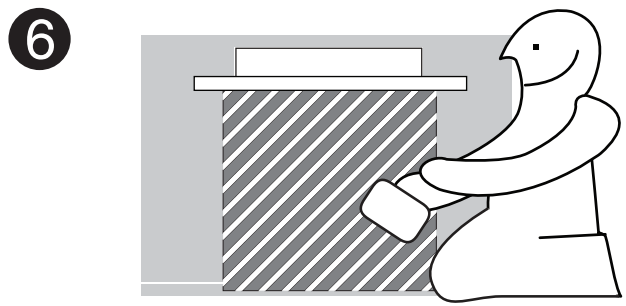

6. Repeat the process until the material has been adhered to the entire surface.

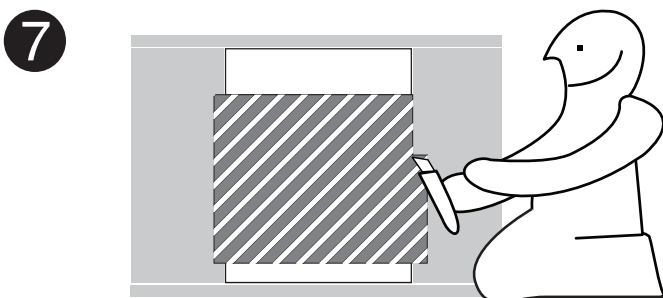

7. Trim to fit with a utility knife.

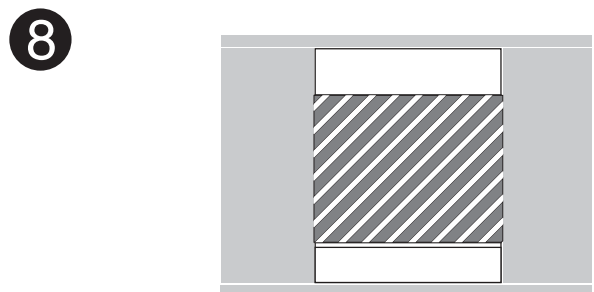

8. Your vinyl cover is installed!